



T- Hangar Diagrams

Fees effective May 1, 2023
through April 30, 2024

Northeast T-Hangars

	=	\$581.45
	=	\$662.86
	=	\$790.78

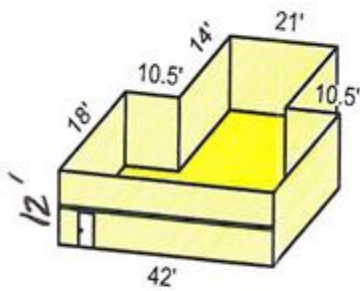

BAY 1 - 7

Approx. 1,050 sq. ft.

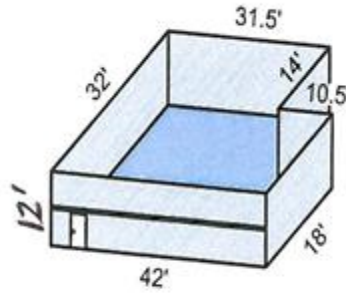

BAY 8

Approx. 1,197 sq. ft.

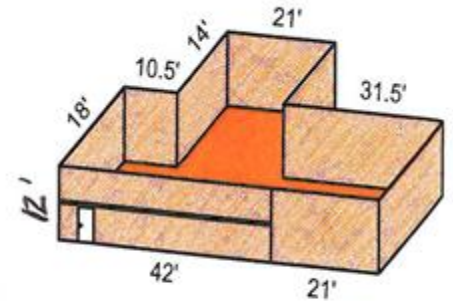

BAY 2X

Approx. 1,428 sq. ft.

Northeast T-hangar

Approximate door opening height: 11'8"

**Prices will adjust May 1st.*

T- Hangar Diagrams Southwest T-Hangars

N54-42

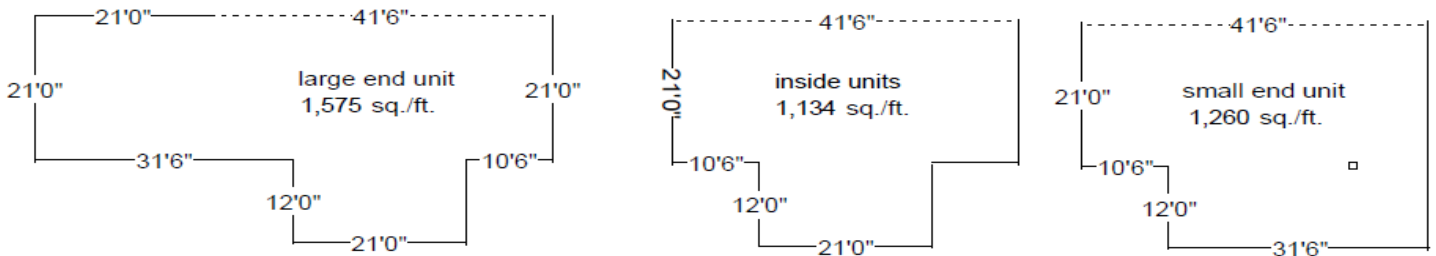

N60-45

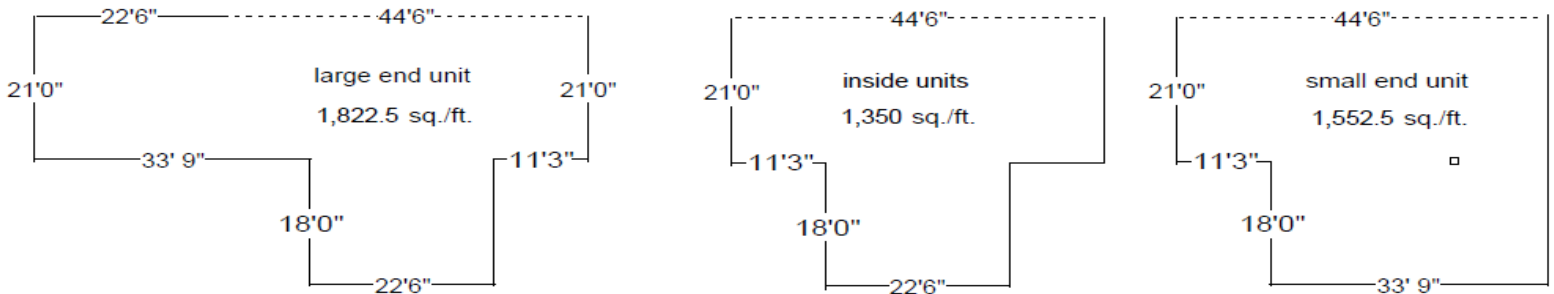

N54-42 (TH50)

Large End Unit (50-2) = \$872.04

Inside Units (50-3 thru 50-10) = \$627.87

Small End Unit (50-1) = \$697.63

Approximate door opening height: 11' 4"

N60-45 (TH51)

Large End Unit (51-9) = \$1,009.07

Inside Units (51-1 thru 51-8) = \$747.46

Small End Unit (51-10) = \$859.58

Approximate door opening height: 13' 5"

**Prices will adjust May 1st.*